

# iTach Family of Products

## Connect almost any device to a network.

The Global Caché iTach is a family of products designed to connect almost any electrical device to a network in a matter of minutes. Based on open systems and industry standards, the ultra-compact device fits almost anywhere (even the palm of your hand)) and includes a choice of wireless WiFi or wired TCP/IP connectivity to infrared (IR), serial (RS232), and contact closure (relay) equipment.

The innovative design of the Global Caché iTach allows for easy and flexible integration into any networked control solution. The iTach is a simple wired or wireless conduit between you and your device over a network or the Internet. This is instant network-enabling at its best, delivering the power of choice at a cost-effective price.

### iTach Models

#### Model WF2IR

- The iTach WF2IR provides WiFi connectivity to IR devices

#### Model IP2IR

- The iTach IP2IR provides wired TCP/IP connectivity to IR devices

#### Model IP2IR-P

- The iTach IP2IR with PoE option

#### Model WF2SL

- The iTach WF2SL provides WiFi connectivity to serial devices

#### Model IP2SL

- The iTach IP2IR provides wired TCP/IP connectivity to serial devices

#### Model IP2SL-P

- The iTach IP2SL with PoE option

#### Model WF2CC

- The iTach WF2SL provides WiFi connectivity to contact closure devices

#### Model IP2CC

- The iTach IP2IR provides wired TCP/IP connectivity to contact closure devices

#### Model IP2CC-P

- The iTach IP2CC with PoE option



### Key Features

- Connects almost any electrical device to a network instantly
- Access, monitor, and control stand-alone equipment
- Wired, wireless, and PoE models available
- Supports eight simultaneous connections
- Ultra compact design, stylish enclosure can fit almost anywhere
- On board web server for easy setup, HTTP, DHCP
- Flash upgradeable for firmware enhancements in the field
- Made in the USA and RoHS compliant



# iTach WiFi to IR

## Technical Specifications

Wirelessly connect, monitor, and control Infrared devices over a network and the Internet. The iTach provides a new level of control flexibility, enabling device networking without wiring. The product is based on open systems and industry standards for easy integration and compatibility.

### Network connection - Industry standard 802.11b wireless interface, 2.5" antenna

- Supports wireless LAN Ad-Hoc and Infrastructure modes
- Compatible to 802.11b/g

### IR Ports - 3 independent user selectable IR outputs or sensor inputs

- 3rd port supports IR blaster
- 3.5mm mono
- 3 IR emitters, 1 IR blaster included

### IR Learning - Full spectrum IR learner built in

- IR learner utility available on Global Caché website (no charge)

### Indicator LEDs

- Power
- IR learning
- IR ports (3)

### Device Packaging

- Material - Aluminum extrusion case, rubber end caps, plastic face plates
- Dimension - (LxWxH) 3.25 x 2.25 x 1.25 in.
- Weight - 3.25 oz (6 oz. with power supply)

### Shipping Dimensions

- (LxWxH) 6 x 3 x 2 in.
- Weight 1 lb.

### Warranty

- Two year limited warranty



## Adhoc Network (Peer-to-Peer)

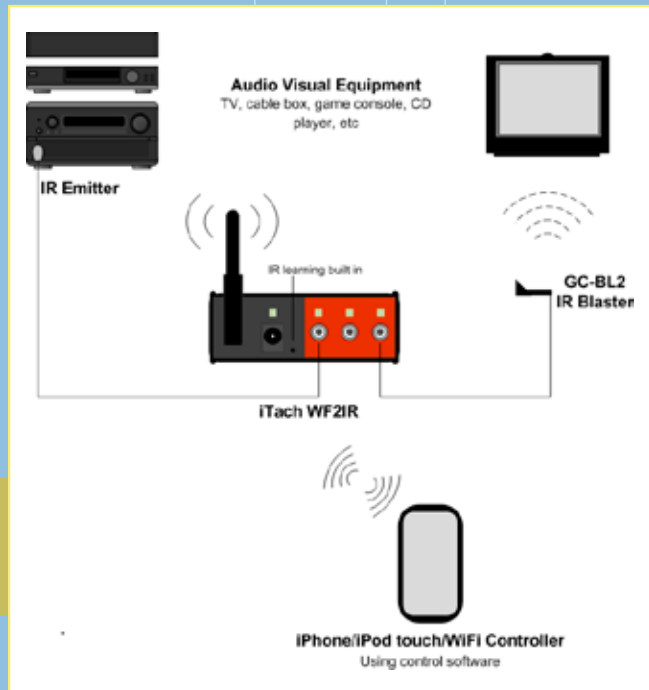

## Infrastructure Network

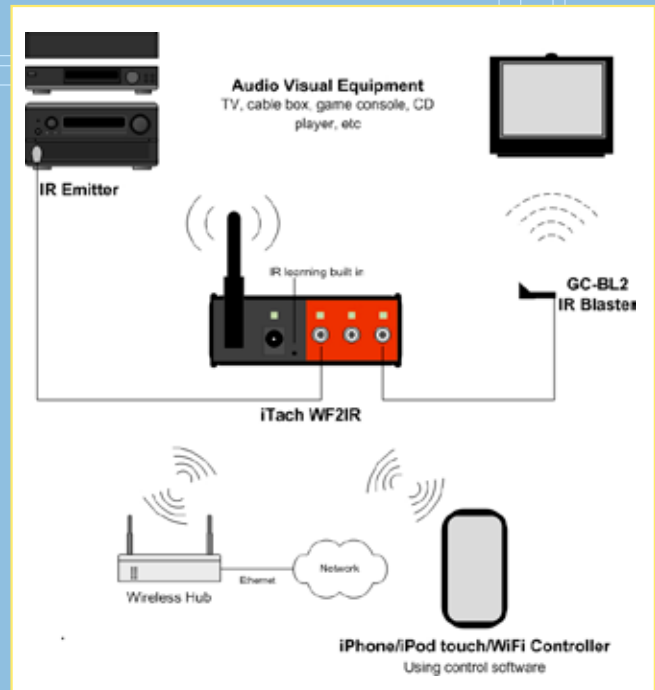

### Corporate Headquarters:

160 East California Street  
PO Box 1659  
Jacksonville, Oregon 97530 U.S.A.  
Telephone: 541-899-4800  
Fax: 541-899-4808  
www.globalcache.com - info@globalcache.com

